

1020 Series Flex Check Valve

SPECIFICATIONS

- THE DISC IS PRECISION MOLDED WITH AN INTEGRAL O-RING TYPE SEALING SURFACE AND CONTAINS ALLOY STEEL WITH NYLON REINFORCEMENT IN THE FLEXIBLE HINGE AREA
- A THREADED PORT WITH PIPE PLUG ON THE BOTTOM OF VALVE TO ALLOW FOR FIELD INSTALLATION OF A BACKFLOW ACTUATOR
- SLAMMING AND WATER HAMMER VIRTUALLY NON-EXISTENT DUE TO ITS SHORT CLOSING TRAVEL
- FULL STOP-ENTRY ACCESS FOR EASY ON-LINE INSPECTION AND MAINTENANCE
- FLANGED AND DRILLING COMPLY WITH ANSI/ASME B16.1 CLASS 125
- CONFORMS TO AWWA C-508
- SIZES 2"-12" IN STOCK. SIZES 14"-24" SPECIAL ORDER ONLY



COMPONENTS

PART NAME	MATERIAL	ASTM SPECIFICATION
BODY	DUCTILE IRON	A536 65-45-12
COVER	DUCTILE IRON	A536 65-45-12
DISC	EPDM	
GASKET	D2000 EPDM	
PLUG	MALLEABLE IRON	A47 GRADE 22010
FASTENERS	STAINLESS STEEL	

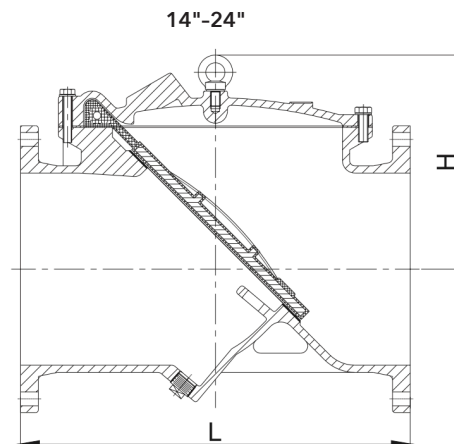
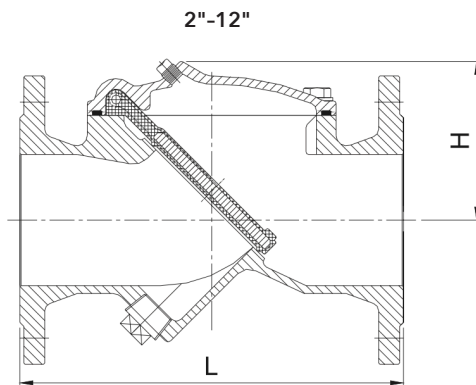

DIMENSIONS

	(INCHES)												
SIZE	2"	2 1/2"	3"	4"	6"	8"	10"	12"	14"	16"	18"	20"	24"
L	8.0	8.5	9.5	11.5	15.0	19.5	24.5	27.5	31.0	32.0	36.0	40.0	47.6
H	3.7	3.7	4.2	4.8	6.3	8.3	9.8	11.4	15.4	17.7	19.5	21.1	24.4